

SYSTEM FOR WATERPROOFING BATHROOMS WALLS & SHOWER AREAS



Summary of application

STEP 1: Concealment of bathroom utility lines using **Crack Heal 910** or **Crack Heal 910 2K**.

STEP 2: Plastering of the bathroom walls using **Ressi SBR 5850** and **Silmix** in the plaster mix.

STEP 3: Application of **Water Guard 491** on plastered surface.

STEP 4: Finishing by the application of Tiles using **Ressi TA 230** & **Ressi TG Bathseal 2K**.

Detailed description

Bathroom walls should be treated in such a way that there is no issue of dampness or paint peel off in the opposite wall of the bathroom. It is not unusual to see issues of dampness & paint peel off on the opposite sides of bathroom walls.

It is for this reason Ressichem presents a variety of products as a systematic solution for bathroom walls.

Step 1: Concealment of bathroom utility lines

Once the walls have been erected, it is essential to make sure that all the plumbing lines and utilizes which are concealed are done so properly. It is recommended to use **Crack Heal 910** for new bathroom walls to fill the utility conduit properly protected with a metal mesh (Please refer to conduit filling system for new walls). In case of renovation, it is recommended to use **Crack Heal 910 2K** for this application (Please refer to conduit filling system for renovations). Once the conduits have been properly filled and treated, it is essential to plaster the bathroom walls the proper way.

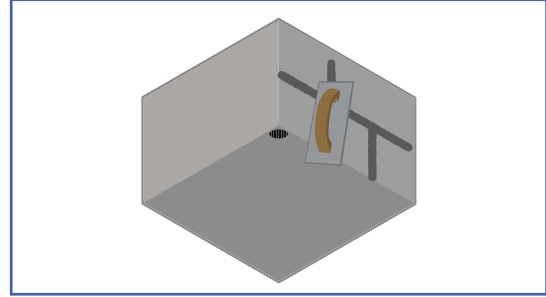

Step 2: Plastering of the bathroom walls

It is essential to plaster the washrooms the right way, it is recommended to add **Ressi SBR 5850** and **Silmix** in the plaster of the washroom. The recommended dosage for to use in the plaster is 1 Ltr of **Ressi SBR 5850** and 1 Ltr of **Silmix** each with every 50 KG bag of cement. It is also recommended to roughly finish plaster and make sure that it is not smooth after finishing. This is done with the intention of providing a rough key for the subsequent application of **Water Guard 491** and the Tile Adhesive of **Ressi TA 230**.

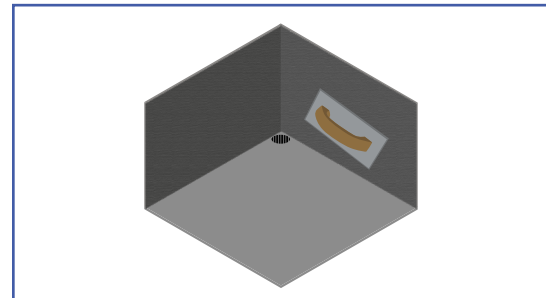

SYSTEM FOR WATERPROOFING BATHROOMS WALLS & SHOWER AREAS



STEP 3: Application of Water Guard 491 on plastered surface

To protect the water penetrating the plastered surface, it is recommended to apply 2 coats of **Water Guard 491** over the plastered surface. 2 coats of the material are recommended over the plastered surface. Both the coats should be applied in right angled opposite directions (If the first coat is applied in top to bottom direction, the second coat is to be applied in right to left direction). It is specially recommended for shower areas that **Water Guard 491** is applied in the complete length of the vertical walls.

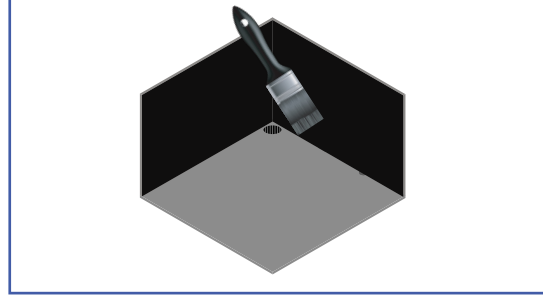

STEP 4: Finishing

If tiles are not applied, a variety of cementitious finishes can be applied over the wall surface of **Water Guard 491** (Please refer to our range of decorative platers). **Ressi TA 230** is the recommended waterproof tile adhesive for the bathrooms. It is an ideal tile adhesive for standard ceramic, porcelain, and large format tiles. The Recommended tile grout to be used in this case is **Ressi TG Bath seal 2K**. It is a mild acid resistant tile grout which does not deteriorate as quickly as ordinary cement or standard tile grout (Please refer to the technical datasheets of the product for more information).

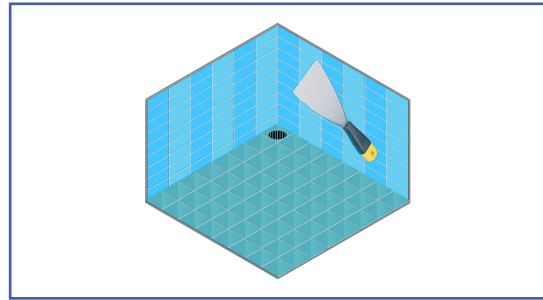
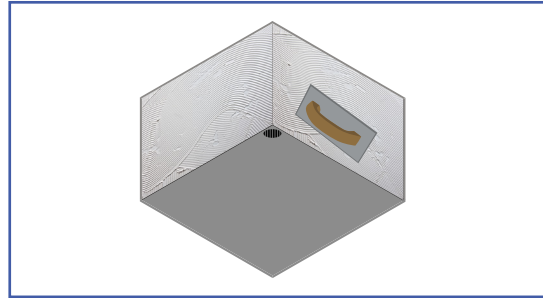

SYSTEM FOR WATERPROOFING BATHROOMS WALLS & SHOWER AREAS

RESSICHEM[®]
adding life and value to your property

System Summary

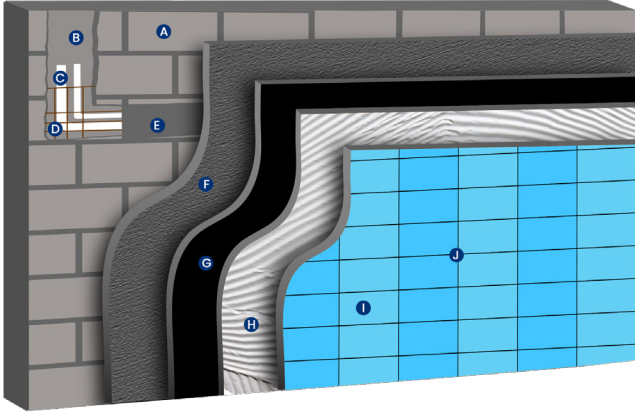

WATERPROOFING SYSTEM FOR (BATHROOMS WALL)

A: Block / Brick Masonry
B: Cutting open masonry wall
C: Conduit pipes
D: Metal Mesh
E: Crack Heal 910 / 910 2K
F: Base Plaster (Silmix + Ressi SBR 5850)

G: Water Guard 491
H: Ressi TA 230 (White or Grey)
I: Tiles
J: Ressi TG Bathseal 2K