

# COLORED PLASTER 12MM TO 25MM

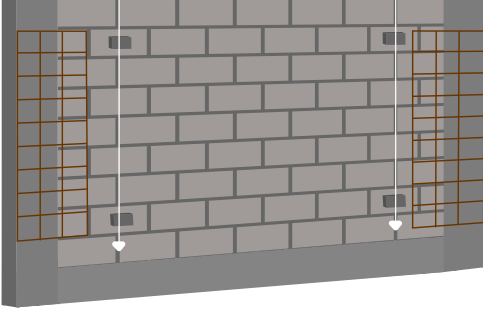

## Summary of application

**STEP 1:** Surface preparation with metal mesh between the joints of concrete and masonry and application of levelling Dabs.



**STEP 2:** Application of **Ressi PlastoRend 120 C** directly on prepared masonry & the Concrete Surface.

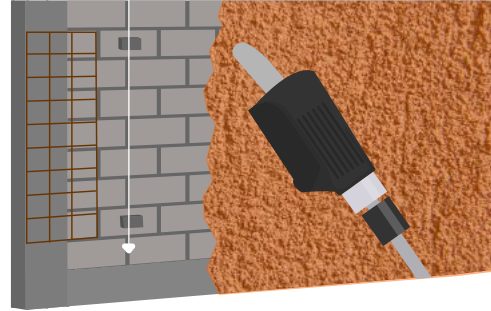

**STEP3:** Finishing the surface as required.

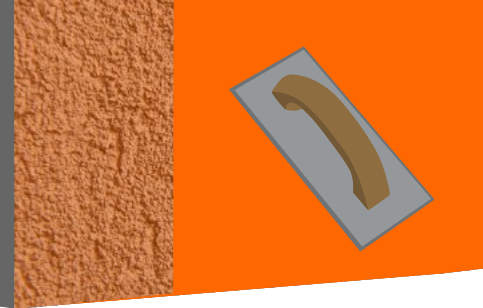

**STEP 4:** Application of **Silblock (Water repellent sealer)** for long term plaster protection.

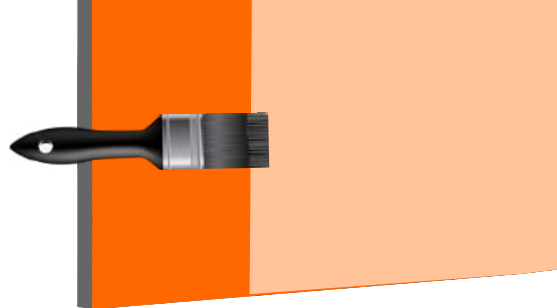

## Detailed description

Block masonry and concrete surfaces can directly be finished using a pigmented ready to use thick applied plastering and rendering materials. The product that can be used to achieve this is **Ressi PlastoRend 120 C**.

**Ressi PlastoRend 120 C** is a ready to use thick applied pigmented plaster which is available in many standard colors. Only the addition of an appropriate amount of water is required on site to achieve the desired plaster consistency. These plasters can be applied by hand & can also be sprayed over the wall surface of masonry or concrete using a plaster / render spray machine.

A thick applied decorative plaster once protected with an appropriate sealer is one of the most resilient cementitious surface treatments against environmental impacts. A recommended sealer to protect **Ressi PlastoRend 120 C** against environmental damages is **Silblock Water Repellent sealer**.

It is recommended that the alignment of masonry surface and concrete should be as straight as possible. This will result in the use of minimum material for maximum coverage and output hence minimizing the cost and time used in execution.

Prior to the application of **Ressi PlastoRend 120 C** it is recommended that all the joints between masonry and concrete surfaces are treated with an appropriate method like a wire metal mesh between the RCC and masonry joint. There are several joint sealants (Cement compatible) which can also be used for this application.

## COLORED PLASTER 12MM TO 25MM



### Application using a plaster / render spray machine.

A spray mortar machine is brought to the job site. Electric and water connections are set into the machine. A bag of **Ressi PlastoRend 120 C** is torn into the machine.

Once the machine itself is setup properly, the mortar for Plastering and rendering will be mixed with water and sprayed onto the desired wall or roof surface via means of a spray gun.

Whilst the material is sprayed onto the desired surface, corresponding masons' level the surface following the spray gun plaster.

**After the machine setup, the Ressichem plastering & rendering system can be defined into 5 simple steps.**



#### TEAR:

Continually keep on tearing the bags of Ressichem Plasters & Renders into the Machine.



#### SPRAY:

Keep on spraying the material onto the desired wall or roof surface.



#### FINISH:

The plaster / render should be finished as per the desired finish required.

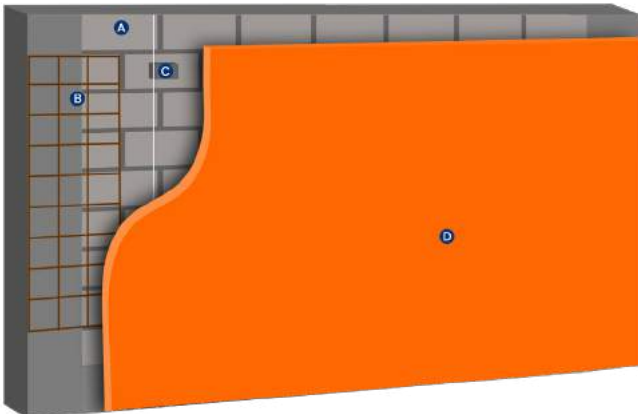

### System Summary

#### COLORED PLASTER 12MM TO 25MM

- A: Block / Brick Masonry
- B: Metal Mesh
- C: Levelling Dabs
- D: Ressi PlastoRend 120 C  
(Final Finished Surface) + Silblock