

BASE GREY PREMIX PLASTER

RESSICHEM[®]
adding life and value to your property

Summary of application

STEP 1: Surface preparation with metal mesh between the joints of concrete & masonry & application of levelling Dabs.

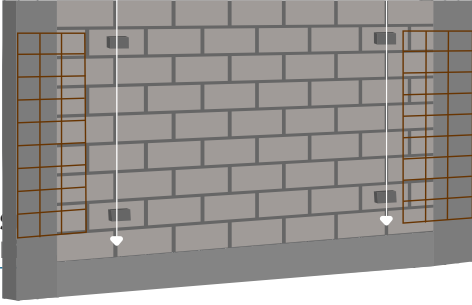

STEP 2: Application of **Ressi PlastoRend 120** directly on prepared masonry & concrete surface.

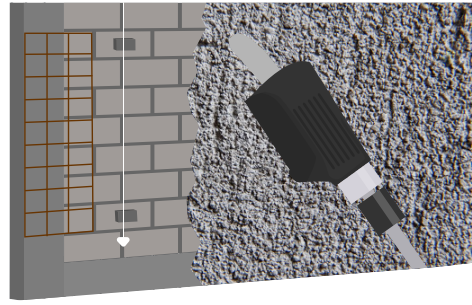

STEP 3: Finishing the surface as required.

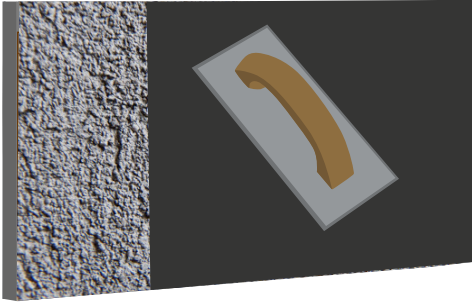

Detailed description

Ressichem premix plasters are ready to use premix powdered plasters that come in a bag form. Only the addition of an appropriate amount of water is required on site to achieve the desired plaster consistency.

Application using a plaster / render spray machine.

A spray mortar machine is brought to the job site. Electric and water connections are set into the machine. A bag of the desired grade of Ressichem or other premix plasters and renders of Ressichem are torn into the machine.

These plasters can be applied by hand and can also be sprayed over the wall surface of masonry or concrete using a plaster / render spray machine.

Once the machine itself is setup properly, the mortar for plastering and rendering will be mixed with water and sprayed onto the desired wall or roof surface via means of a spray gun. Whilst the material is sprayed onto the desired surface, corresponding masons' level the surface following the spray gun plaster.

After the machine setup, the Ressichem plastering & rendering system can be defined into 3 simple steps.

BASE GREY PREMIX PLASTER

RESSICHEM®
adding life and value to your property



TEAR:

Continually keep on tearing the bags of Ressichem plasters & renders into the machine.



SPRAY:

Keep on spraying the material onto the desired wall or roof surface.

System Summary

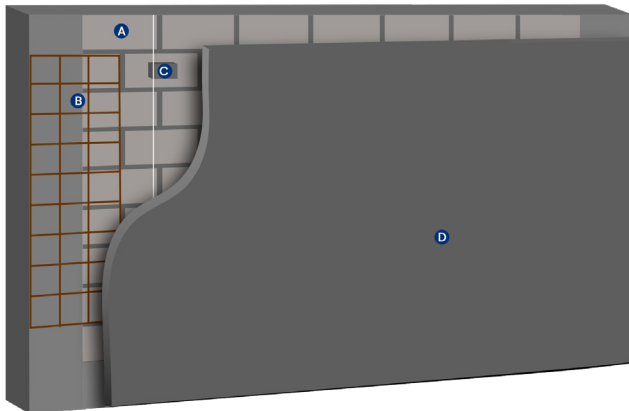

FINISH:

The plaster / render should be finished as per to the desired finish requirement.

For further information on the plastering & rendering system by Ressichem, please refer to the various datasheets & product catalogue



BASE GREY PRIMEX PLASTER

- A: Block / Brick Masonry
- B: Metal Mesh
- C: Levelling Dabs
- D: Ressi PlastoRend 120