



RESSICHEM

adding life and value to your property

Insulaster



ECOLOGICAL



THERMAL INSULATION



HUMIDITY CONTROL



ACOUSTIC



MINIMAL CRACKING



BREATHABLE



FIRE RESISTANCE



COMFORT ALL YEAR ROUND

ریسیکیم
مضبوطی اور پائیداری کے لئے

D-83, S.I.T.E., INDUSTRIAL AREA, MANGHOPIR ROAD, KARACHI - 75530, PAKISTAN

+92-21-32593800-02

WWW.RESSICHEM.COM



Who we are and what we do?

Ressichem was established in 1999, since its inception, we are proud to cater to the needs of the construction and many other industries offering quality products manufactured at our state-of-the-art plant sourced from the best in the world. Raw materials for our products are also sourced from quality suppliers worldwide. Ressichem takes pride presenting a variety of construction materials and systems which can cater to many needs of the construction industry.

They include:

- **Dry Mix Mortars / Premix Plasters**
- **Epoxy Floorings**
- **Building Care & Maintenance**
- **Epoxy Adhesives & Coatings**
- **Tiling & Grouting Materials**
- **Concrete & Mortar Admixtures**
- **Building Insulation**
- **Decorative Concrete**
- **Specialty Products**

Backed by a fully equipped laboratory at our own premises with a team of qualified engineers and chemists. Ressichem carries out regular tests to maintain quality of finished products for various construction & industrial applications. Vigorous onsite support & quality systems allow for maintaining the quality of our products, as well as solve construction and industrial problems. In our effort to maximize customer satisfaction, our technical personnel directly coordinate with customers to offer excellent services,

product selections & even troubleshoot problems where needed.

Operating on a customer first philosophy, Ressichem has carved its name in the ever-demanding needs of its industry, by offering world class services and fulfilling customer requirements via quality manufacturing and rigid quality control of products. We believe that the responsiveness and the priority we attach to the customer needs & their satisfaction has played a pivotal role in our phenomenal growth so far.

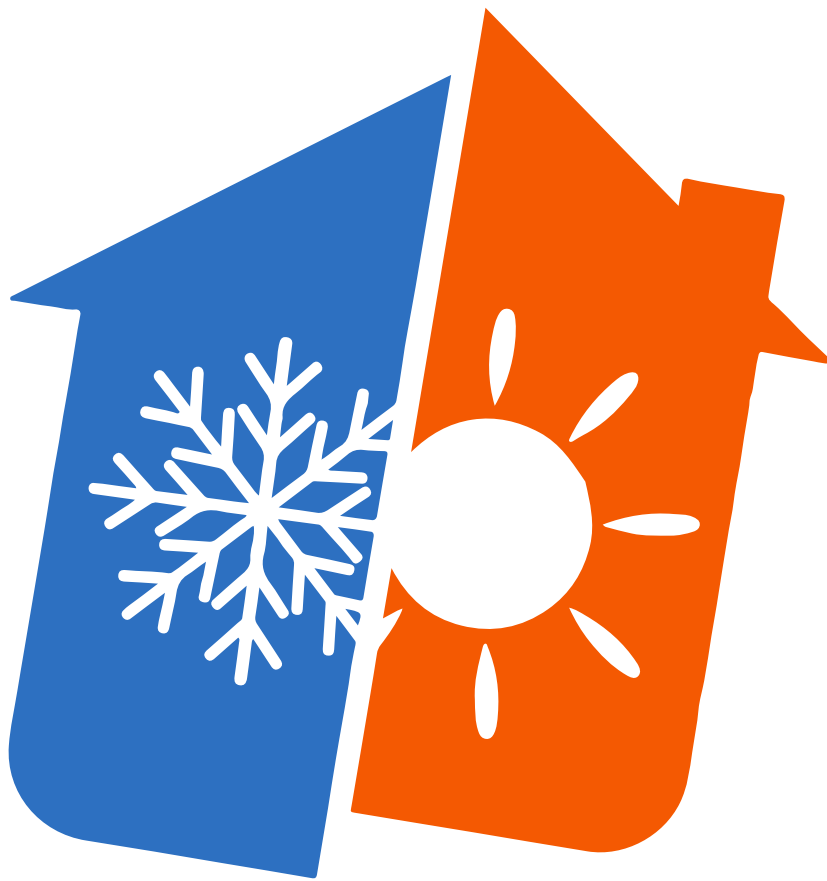

About Insulaster

Insulaster is the first of its kind to be locally manufactured within Pakistan.

It is a ready-made plaster made of inorganic substances providing your house and buildings with thermal, fire & acoustic insulation together. The plaster can be applied on both interior & exterior surfaces of old & new buildings allowing them to breathe.

Insulaster is ideal for the following places



Commercial Buildings



Industrial Buildings

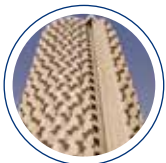

Public Buildings



Institutional Buildings



Residential Buildings



Fire Escape Zones & Equipments Rooms



Advantages



Long Lasting



Ready to use



Easy Application



A1 classification: Can bare 1000 C for 3 hours.



Saves Energy



Provides superior sound proofing



Protection from Thermal Shocks



Does not allow heat transfer thus not affected by hot or cold temperature



Natural & Harmless to Environment



Allows the building to breathe naturally



Does not contain carcinogenic material



Does not have an emission of Green House Gases



Surface Preparation



For very hot climatic conditions, the surface maybe dampened with potable water.

All loose particles and oil shall be cleaned off the surface prior to application.



Note: Over RCC and smooth concrete surfaces, a bottom coat of **Ressi BRC 7000** maybe used if required.

Product Preparation

For manual application it is important that water is pre-measured in accordance with the amount of material used. Generally, 800 millilitre - 1.2 litre of water is required for the preparation of 1 kg of Insulaster.

The Mortar powder should be added over the water to avoid settlement of the material at the bottom of the mixing container.

The mixing should be uncontaminated, non-corrosive and clean using only potable water.

It is recommended to use an automatic drill machine mixer for the mixing of insulaster with water. However, Insulaster can also be sprayed over the surface using a plaster spray machine recommended by Ressichem.

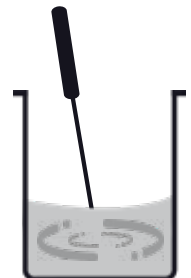
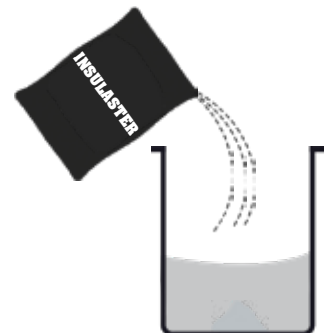
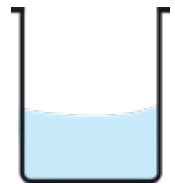

Technical Data

Appearance	Grey Powder
Dry Density	500 - 150 kg/m ³
Thermal Conductivity	0.15 w/mk
Compression Strength	CS II
Bond Strength	0.5 N/mm ²
Water Absorption	W2 0.195 Kg/m ² min ^{1/2}
Vapor Diffusion	%U=6.0 (After 120 days)
Fire Endurance	A1 classification (1000 C for 3 hours)
Readiness for Painting	Drying Time, 72 hours at appropriate environment
Acoustic	15-22 dB
Retention Period	12 months at appropriate environment
Application Type	Plaster machine or Steel Trowel

BLOCK WALL /
CONCRETE SURFACE

INSULASTER

PAINT

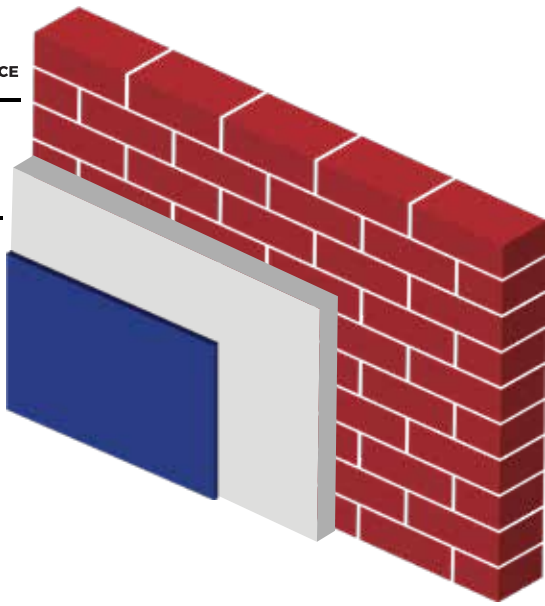

BLOCK WALL /
CONCRETE SURFACE

INSULASTER

PAINT GUARD
10,000 C

PAINT

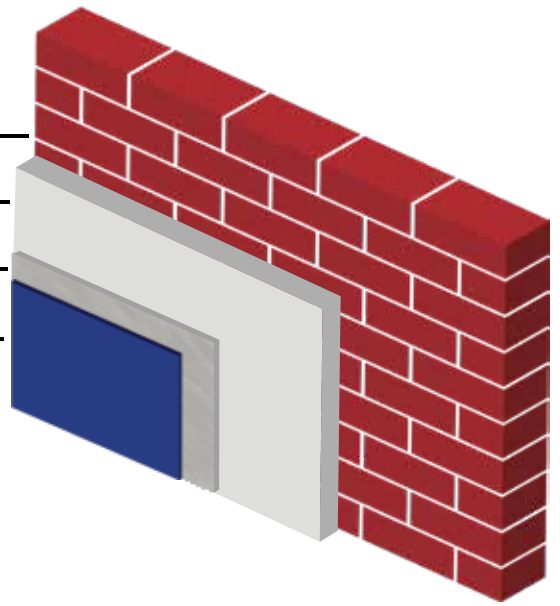

BLOCK WALL /
CONCRETE SURFACE

INSULASTER

RESSI
PLASTOREND 110
Protected with silblock
(Water repellent sealer)

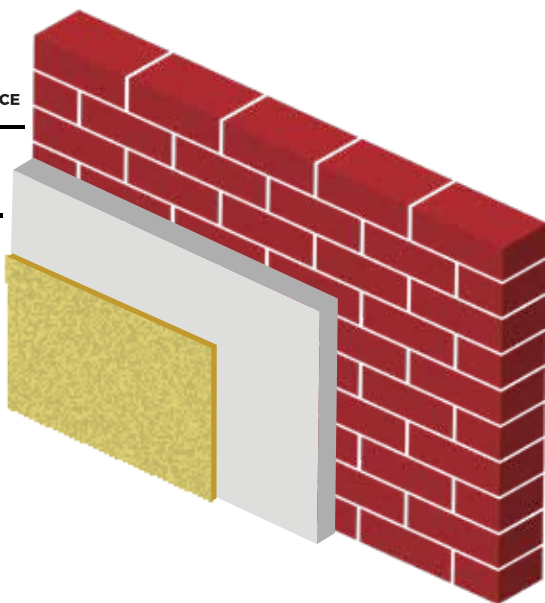

BLOCK WALL /
CONCRETE SURFACE

INSULASTER

RESSI PLASTOREND
120

PAINT

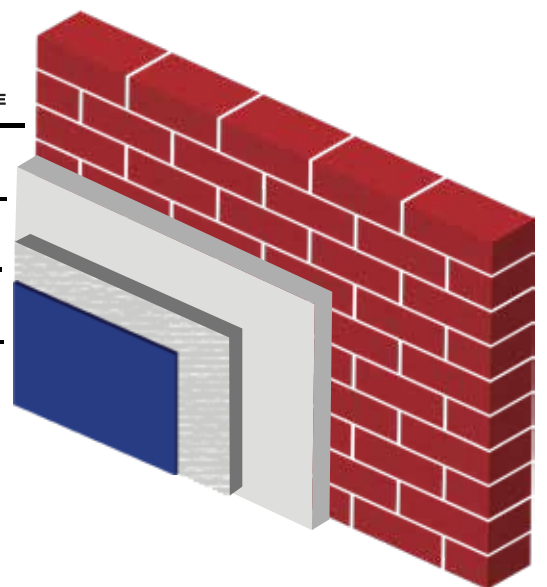

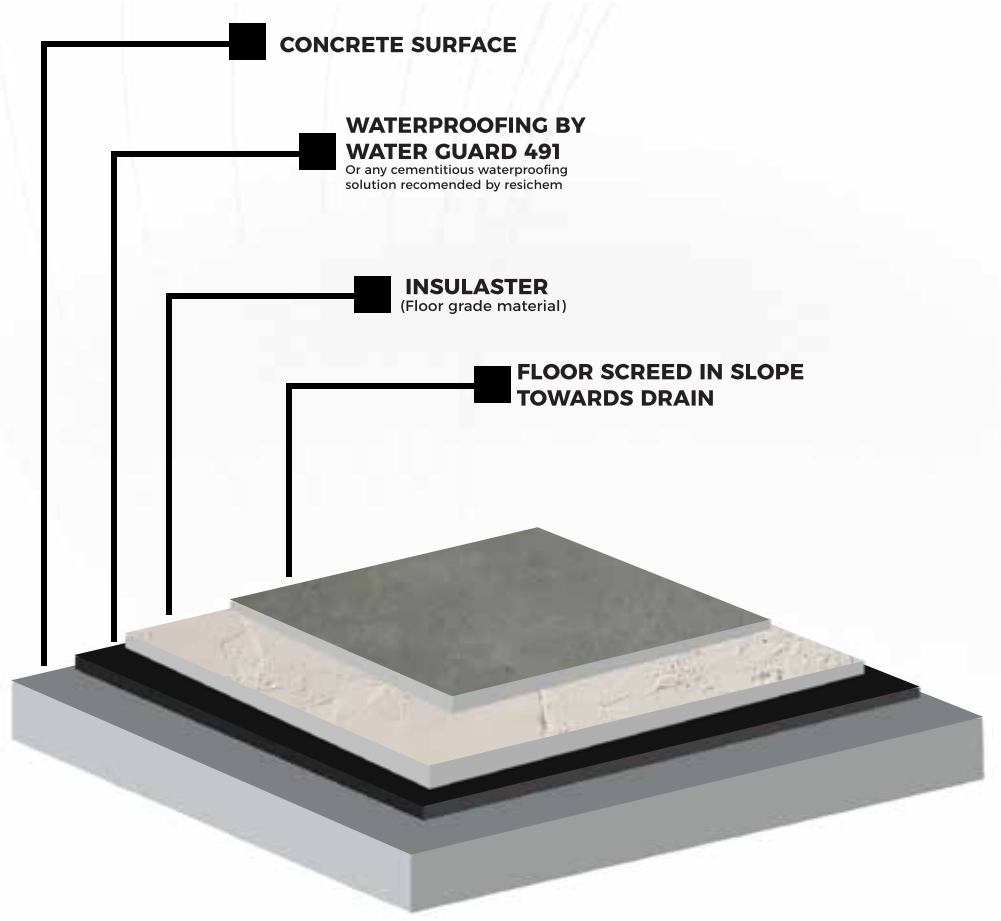
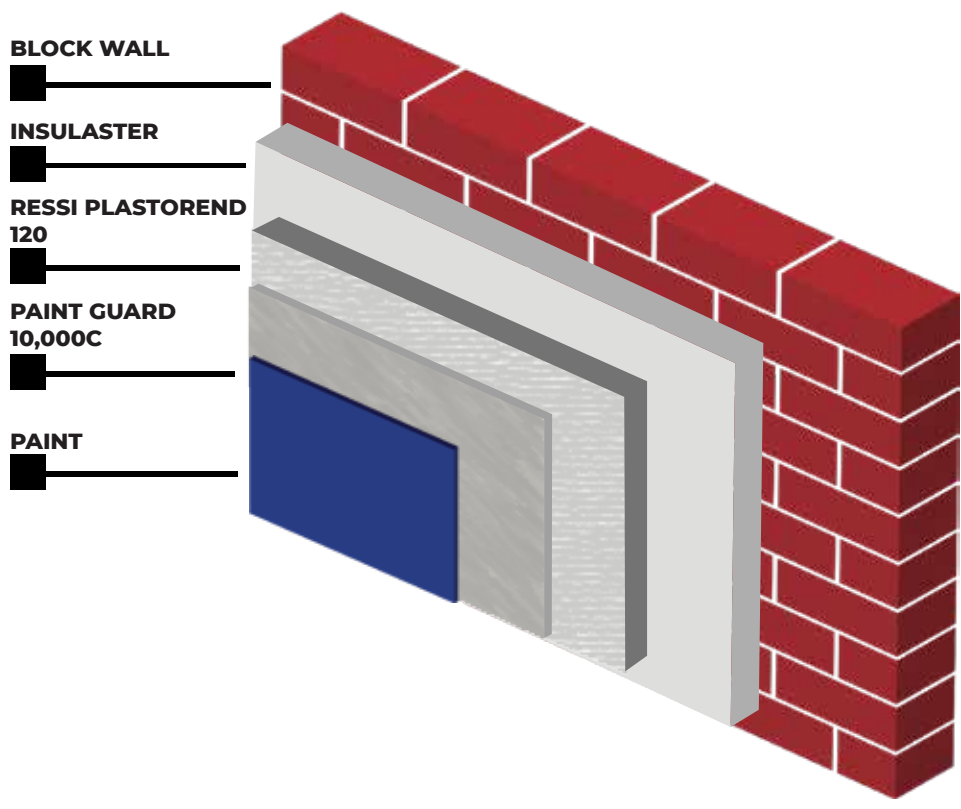



CURING

No curing required in general however maximum in curing for 72 hours where hot climate conditions prevail.

SHELF LIFE

Expiration of Insulaster is 6 months after production under dry and sheltered conditions.



HEALTH & SAFETY

Insulaster is regarded as non hazardous for transportation. Do not reuse bags & containers and dispose them off as per local rules and regulations. Gloves and suitable masks can be worn during application.

PACKAGING

Insulaster is available in 25 KG bags.



SPECIAL NOTE

Before the application of any product like wall putty paint, wallpaper, decorative plaster or any other coating the insulaster must be dried out completely with no moisture content inside of it.





●
RESSICHEM
adding life and value to your property

📍 D-83, S.I.T.E., Industrial Area, Manghopir Road,
Karachi - 75530, Pakistan

🌐 www.ressichem.com ✉ info@ressichem.com

☎ +92-21-32593800-02 | +92-309-7772464

📘 facebook.com/Ressichem

📺 youtube.com/Ressichem